

Elation Lighting | Opti Tri 30 | exploded view

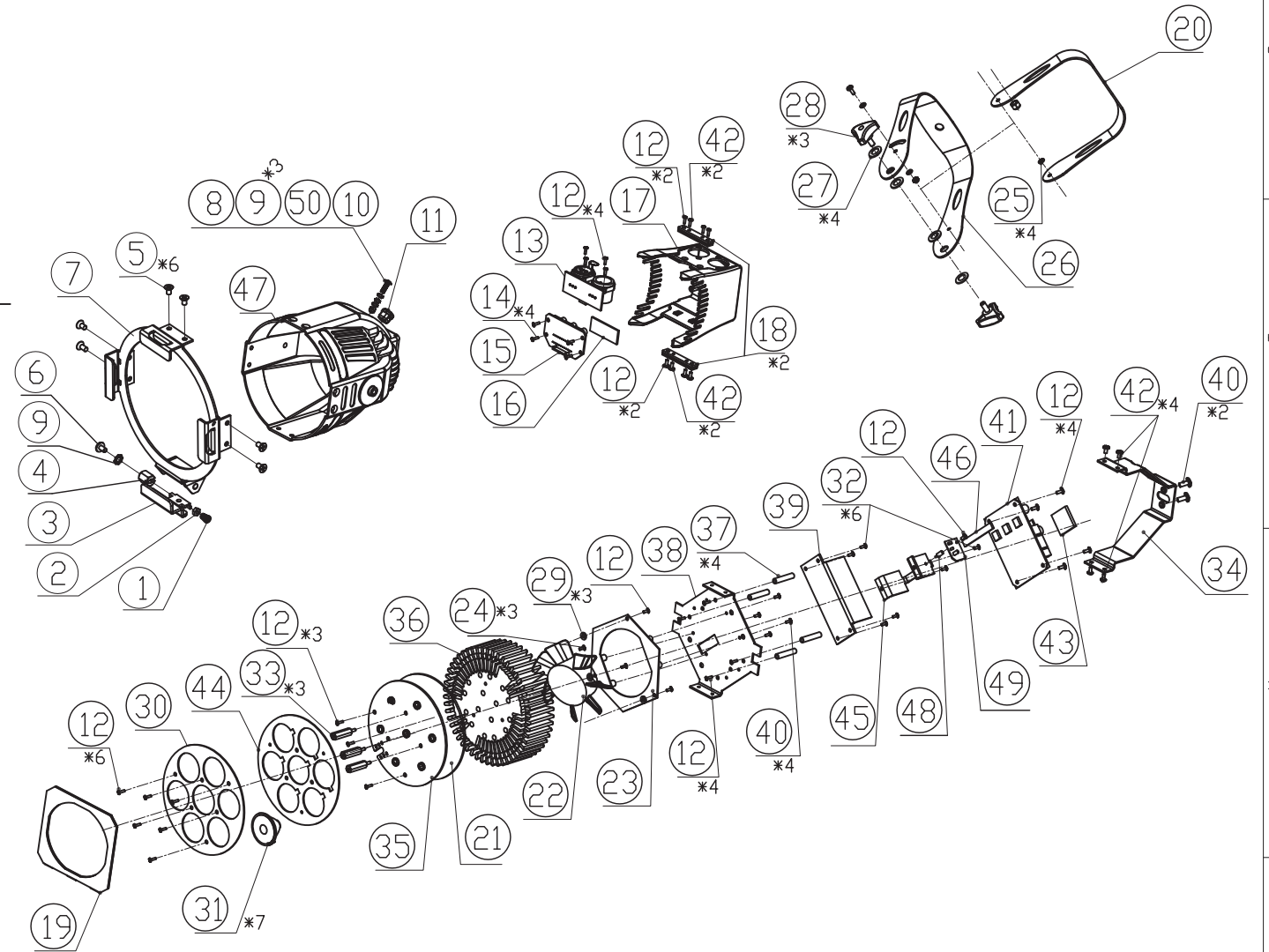

50 W02-100004-01 nut Fe M4\*W7\*H3.2 blue zinc 1

	A	B	C	D	E	F
49	D01-103143-01	FAN-1.0	22.5*40.5*TT1.6+2PIN			
48	W17-100077-01	screw bolt	2.54mm straight needle			
47	W01-106831-01	lamp body	ALΦ131*H149 aluminum die casting black (W1 LED PAR375)			
46	S07-100010-01	insulating rubber	silicon*W10*T1.0red			
45	W01-108050-01	PCB heat sink flake	AL.L65*W23*H32*T2			
44	W01-108045-01	down plate (ADI)	SPCC Φ117*T1.2 black			
43	D01-102007-01	noise control 1W LED PAR375 RGB	VT-MUSTC VER1.1			
42	W03-100096-01	counter head screw	Fe,FM3*Φ6*L6,black nickle			
41	D01-102670-01	main PCB	VT-1WLED PAR48			
40	W03-100046-01	pan head screw	Fe BM4*Φ8*L12 black nickle			
39	D39-100120-01	supply power led	IN:AC90V~264V/47-63HZ/OUT:DC36V/0.83A(safety regulation)			
38	W01-108547-01	spacer plate (turn 90degree)	SPCC.L123*W118*H15*T1.5T,black			
37	W06-100012-01	aluminum cover	AI M3*Φ6*L35 H35			
36	W14-100047-01	heat sink flake	AL6063 anodeΦ11020			
35	D04-100253-01	lamp plate (375 PRO)	VT-LED PAR375-PRO RGB LEDBOARD V3.0			
34	W01-108550-01	bracket (turn 90degree)	SPCC.L121*H96.5*W30*T1.5black			
33	W17-100083-01	iron screw	Fe M3*W5*the screw long 18.3 total long 23.3,black zinc			
32	W03-100287-01	round head screw	Fe PM3*Φ5.4*L6 black nickle			
31	S10-100232-01	lens (KHATOD) 10degree	PLI13310RGB			
30	W01-108043-01	upper plate (ADI)	SPCC Φ117*T1.2 black			
29	S05-100054-01	pakistan fast gasket	black Φ8*Φ4.2*T1.0			
28	S04-100044-01	tripod PC screw	PCheadΦ36*1/4"total long 37*teeth long 17			
27	S05-100064-01	pakistan fast gasket	black Φ16*Φ6.5*T1.0			
26	W01-109644-01	outer bracket (led par375)	SPCC L185*W147*H30*T2.0 black+silke-screen (1 version)			
25	S05-100096-01	pakistan fast gasket	Φ20*Φ10.2*T2.0黑色			
24	W03-100095-01	counter head screw	Fe FM3*Φ6*L6 blue zinc			
23	W01-109408-01	six angle spacer plate	SPCC L95*W95*H10*T1.2 black			
22	D18-100072-01	tripod fan	Φ75.5 DC24Vconnect100/26AWG red and black line 2.54 terminal			
21	S29-100588-01	lamp plate heat sink	silicon Φ110*Φ20*T0.5			
20	W01-108021-01	inner bracket	SPCC L175*W140*H30*T2.0 black			
19	W01-108931-01	octagonal color frame LED PAR375	SPCC 0.61*125*126 (inner hole Φ110) black			
18	W01-106832-01	position bar	AL L50*W10*T5 black			
17	S29-100503-01	controller box	PP3015 L81*W76.6*H95 black			
16	S22-100024-01	display flake	acrylic L40*W16*T3.0 red			
15	D01-102655-01	PCB	there keys display board (red)			
14	W03-100375-01	round head tan cutting self-tapping screw	Fe,PT3*Φ5.3*L8 black nickle			
13	D01-102352-01	DMX assembly	SPIN DMXimport assembly			
12	W03-100392-01	self-tapping screw	Fe M3*Φ5.4*L8 round head triangular teeth black nickle			
11	S24-100004-01	line deduction	PA66 5N-4 H11 black			
10	W02-100030-01	nylon nut	Fe M4*W7*H5 blue zinc			
9	W04-100085-01	outer teeth	Fe Φ8.9*Φ4.2*T0.4 blue zinc			
8	W03-100321-01	earth screw	cooper facing M4*Φ9*L12			
7	W01-108691-01	filter bracket	SPCC.L144.2*W131.4*H34.5*T1.5,black			
6	W03-100034-01	pan head screw	Fe,BM4*Φ7*L6,black nickle			
5	W03-100102-01	counter head screw	Fe,FM4*Φ8*L6,black nickle			
4	W01-108695-01	filter frame baffle screw 2	Fe,regular L11.5*opposite side 8.5,black			
3	W01-108696-01	filter frame baffle	SPCC.L38*W18.4*H27.6*T2.0,black			
2	W02-100001-01	nut	Fe,M3*W5.2*H3,black nickle			
1	W05-100021-01	tower-shaped spring	spring glass, Φ3.8*Φ6.2*Φ0.4*H7.8 norm			